



# Microsys International (S) Pte Limited

ELECTRICAL CHARACTERISTICS	
RATED POWER	260 Wp
OPEN CIRCUIT VOLTAGE (V <sub>oc</sub> )	44.60 V
MAXIMUM POWER VOLTAGE (V <sub>mp</sub> )	35.85 V
SHORT CIRCUIT CURRENT (I <sub>sc</sub> )	7.82 A
MAXIMUM POWER CURRENT (I <sub>mp</sub> )	7.25 A
MODULE EFFICIENCY (%)	13.2
OUTPUT TOLERANCE (%)	±3
CELLS	72
CELL LAYOUT	12x6
MAXIMUM SYSTEM VOLTAGE	1000 VDC

ELECTRICAL CONNECTION	
JUNCTION BOX	IP 65
OUTPUT TERMINAL	MC4 / MC3 Type / Compatible
PROTECTION	SCHOTTKY BY – PASS DIODES

MECHANICAL CHARACTERISTICS	
MODULE DIMENSIONS (mm)	1986x994x46
WEIGHT (KG, APPROX)	28

ABSOLUTE MAXIMUM RATINGS	
OPERATING TEMPERATURE	-40° C to + 85° C

GENERAL	
FRAME	ANODISED ALUMINIUM
FRAME COLOUR	NATURAL (OTHER COLOUR ON REQUEST)

TEMPERATURE CO-EFFICIENT		
$\alpha_{Isc}$ %/°C	$\beta_{Voc}$ %/°C	$\gamma_{Pmp}$ %/°C
+0.1	-0.34	-0.46
NOCT	47±2°C	

WARRANTY	
5 YEARS PRODUCT WARRANTY	
0 - 10 YEARS FOR 90% OF RATED POWER	
10 – 25 YEARS FOR 80% OF RATED POWER	

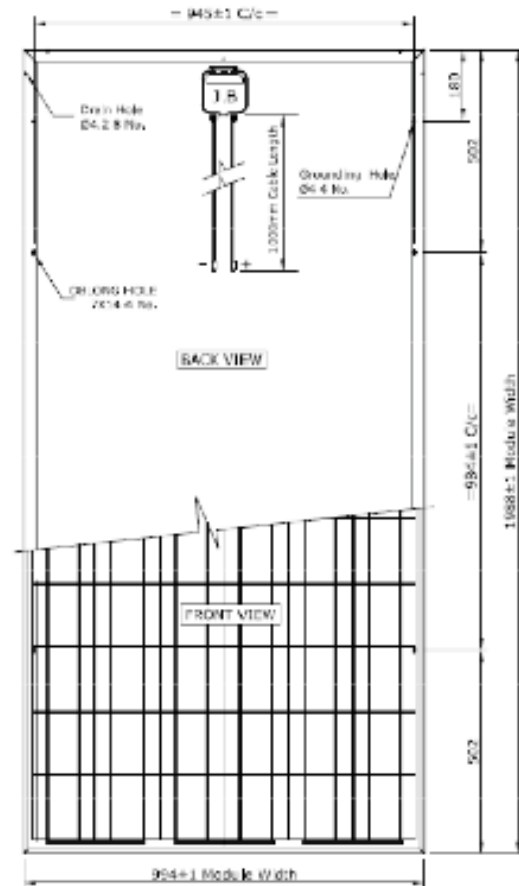

Registered Office: 58, Mariam Way, Singapore 508577  
 Business Address – 30 Loyang Way, # 04-13 Loyang Industrial Estate, Singapore 508769  
 Tel - +65-65465756; Mob +65 90896632,83635550